

**ZO
MO
DO**

ZOMODO.CA

FAUCET INSTALLATION

**ZO
MO
DO**



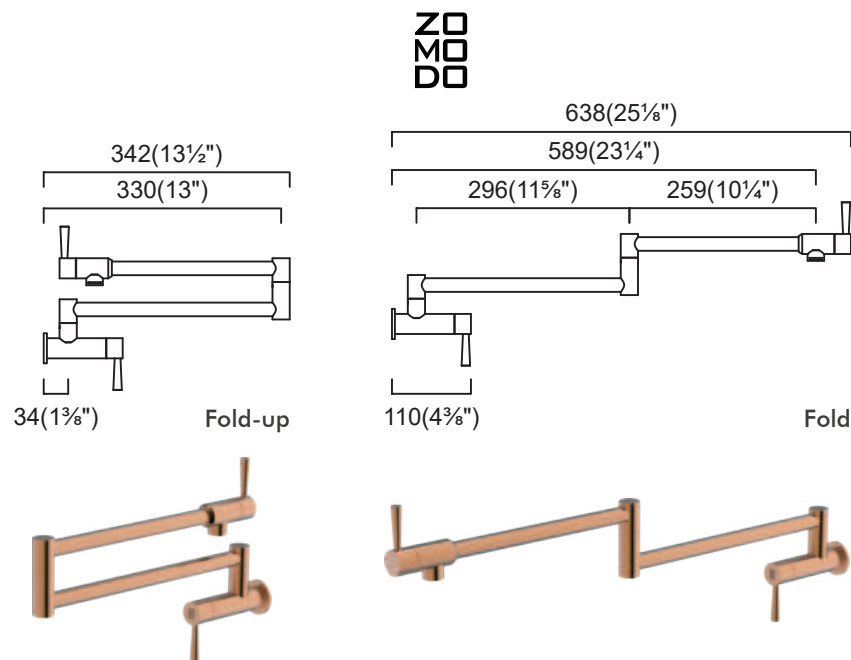

Care and Maintenance

In order to ensure proper function over the lifetime of the faucet, smoothly operate the handle during use. When installing do not over tighten the locking nut. Regularly clean the faucet with a soft, damp cloth and avoid abrasive cleaners, steel wool, and strong chemicals.

Working Specifications

Working pressure: 20-100 psi

Working temperature: 1-60°C

This faucet must be installed with isolating/wall valves in accordance with local installation codes. All ZOMODO faucets must be installed by a licensed plumber. Improper installation will void the warranty.

Notes

1. All pipework must be thoroughly flushed prior to installation as foreign materials may block the flow .
2. Aerator and the flow control can be removed with standard tool and cleaned.
3. If a screen-filter is fitted into the faucet, remove it and flush the pipes and faucet to remove grit. Then re-insert the screen.

KTC043

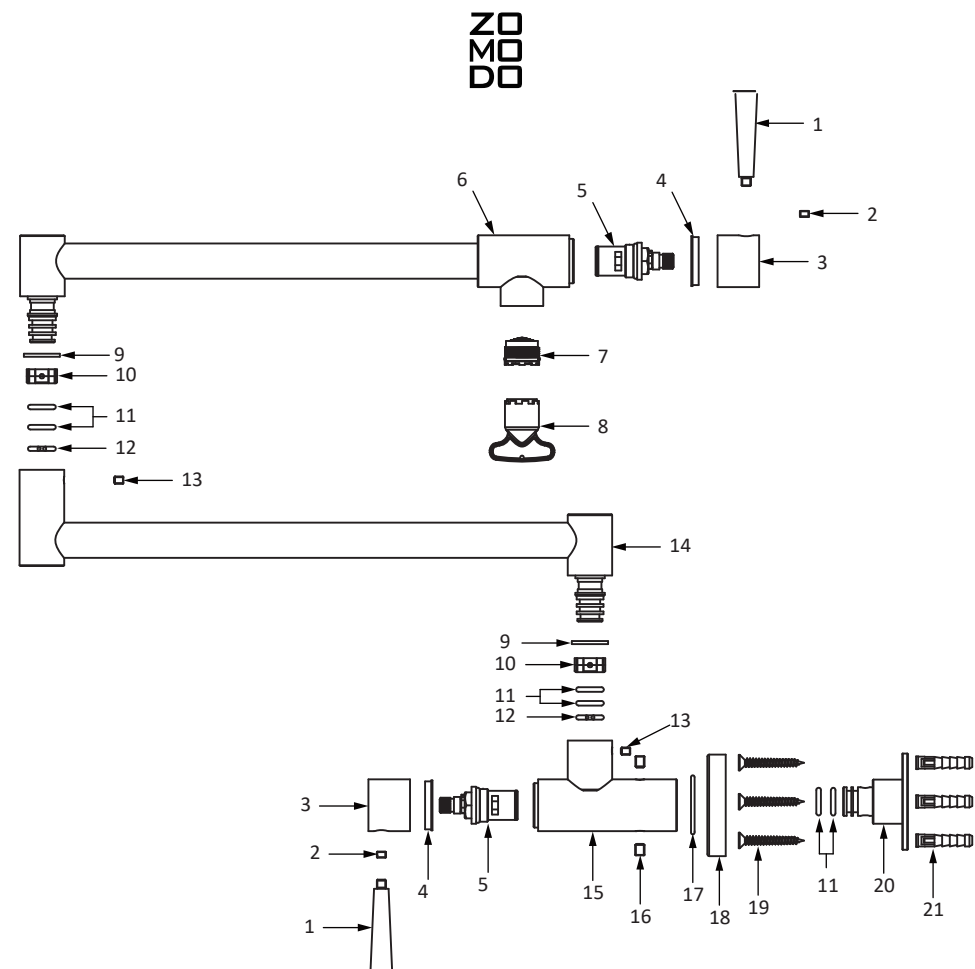

Parts List

- | | | |
|-----------------------------------|---------------------|--------------------|
| 1 Pin lever | 2 Cover | 3 Handle cap |
| 4 Locking Screw | 5 Cartridge | 6 Spout |
| 7 Aerator | 8 Aerator key | 9 Guide washer |
| 10 Guide sleeve | 11 O-ring | 12 Guide nut |
| 13 Cover | 14 Swing Arm | 15 Faucet body |
| 16 Hexagon socket flat head screw | 17 O-ring | 18 Cover |
| 19 Screw | 20 Mounting bracket | 21 Expansion screw |

KTC043

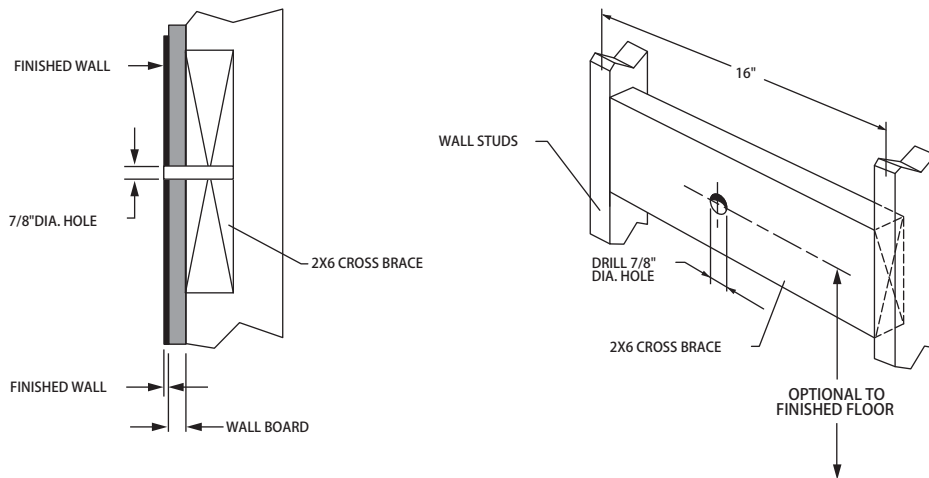

Step 1

Install a 2x6 Cross Brace within the wall between the Wall Studs. And determine the supply height from the finished floor and drill a 7/8 inch dia. hole at that location

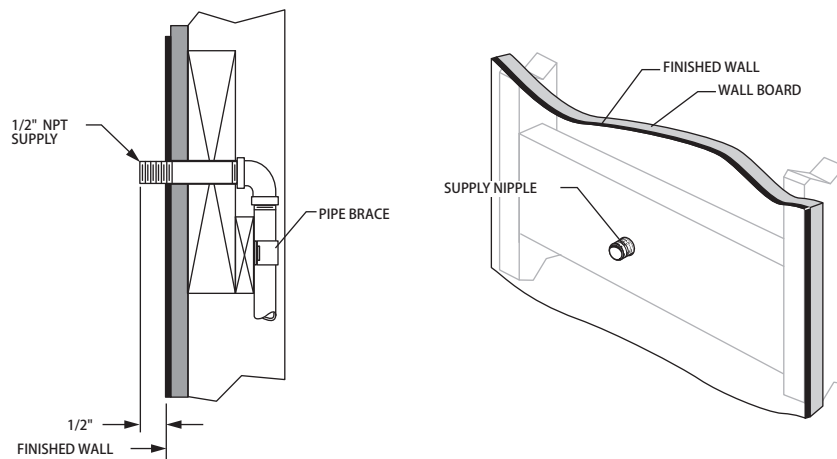

Step 2

Install the 1/2" NPT cold water supply. Secure supplypipe to the Cross Brace. Finish installing the wall board and the finished wall.

- The supply pipe must extend 1/2" from the face of the finished wall.

KTC043

Step 3

Apply plumbers tape to the threads of the supply nipple. Thread the Mounting Bracket onto the supply nipple until tight against the finished wall. Ensure the grub screw holes are facing vertically.

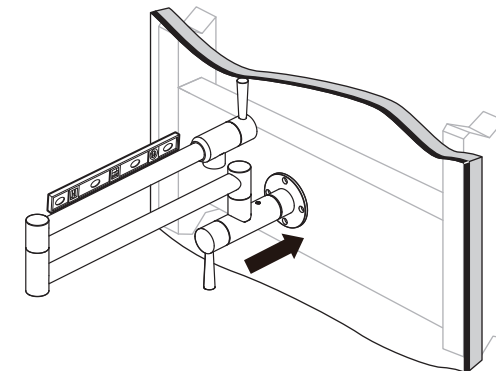
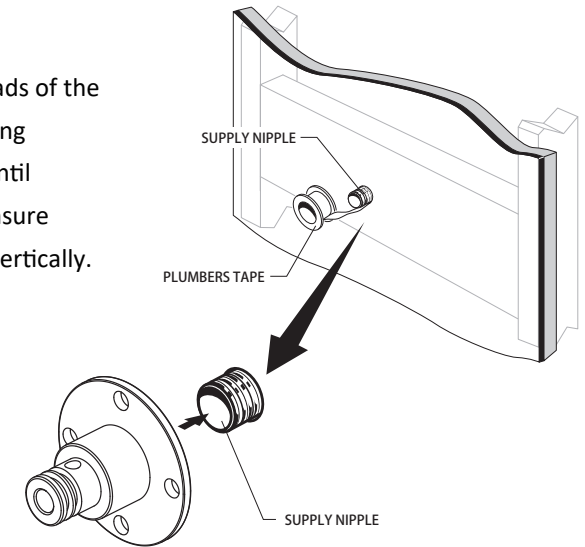

Step 4

Slide the Pot Filler onto the Mounting Bracket, tighten 2 grub screws (16). Check for level.

KTC043

ZO
MO
DO

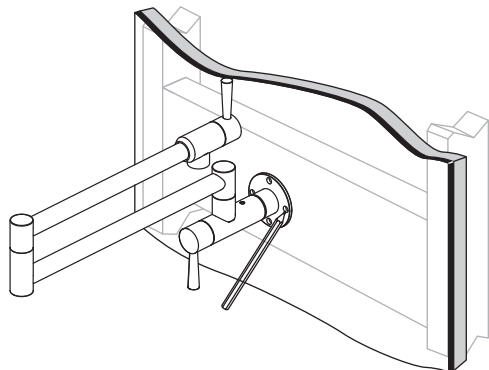

Step 5

Mark the screw holes in the flange. Undo the faucet from the supply nipple.

ZO
MO
DO

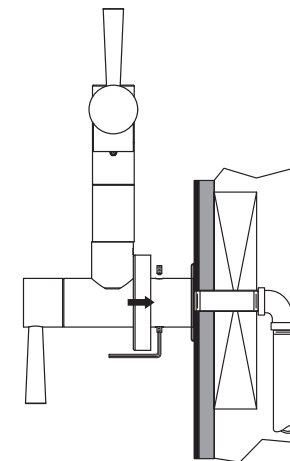
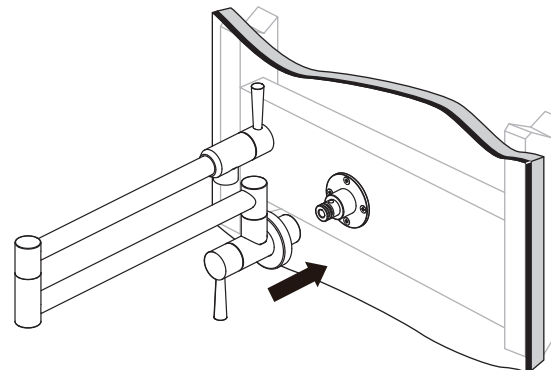

Step 7

Put the cover (18) on the Pot Filler. Slide the Pot Filler onto the Mounting Bracket (20) , tighten 2 grub screws (16) .

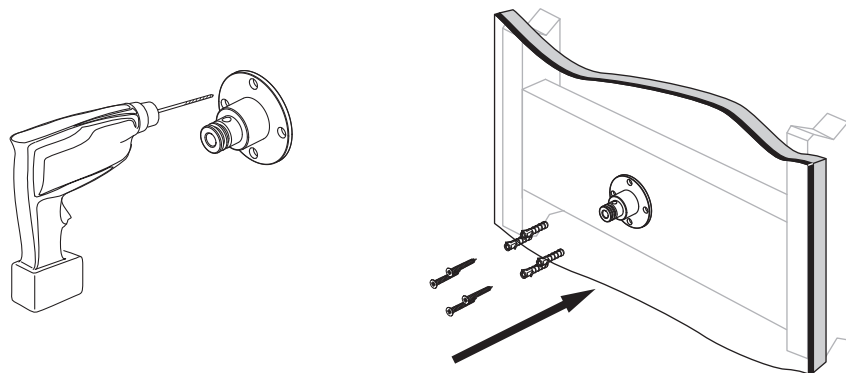

Step 6

Drill 4 pilot holes, secure the Mounting Bracket (20) with the 4 Mounting Screws (19) provided.

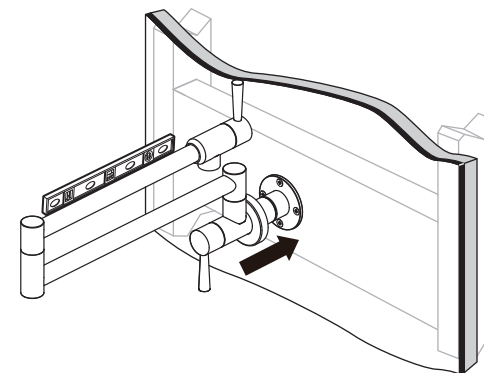

Step 8

Check for level. Again push the wall cover flush against the finished wall.

ZO
MO
DO

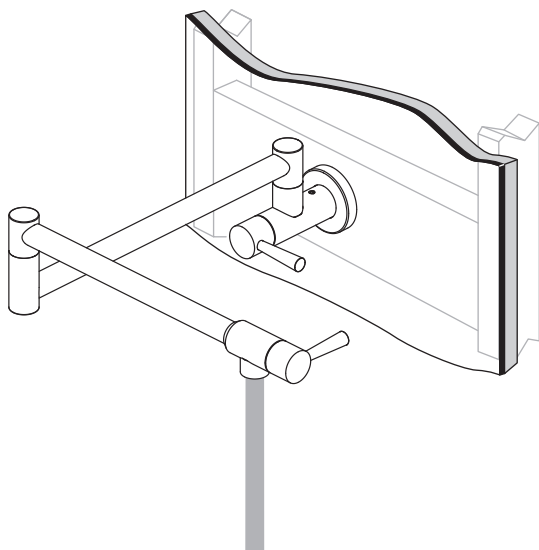

Step 9

Turn on the water supply. Check for leaks and proper operation.