

**ZO
MO
DO**

ZOMODO.CA

TAP INSTALLATION



**ZO
MO
DO**

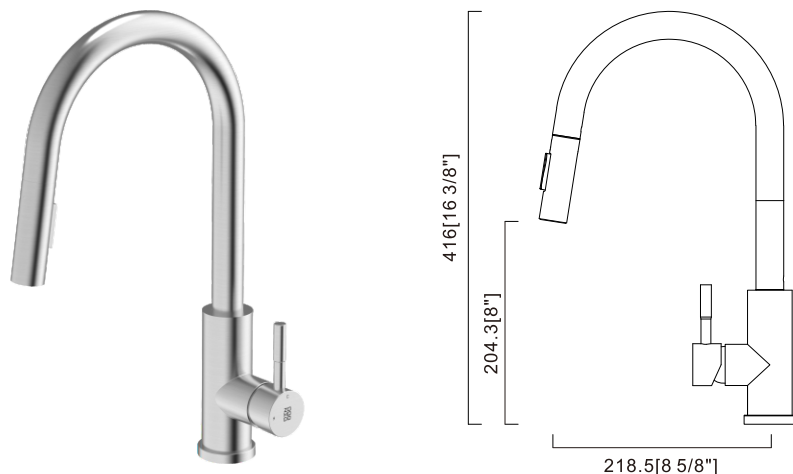

Care and Maintenance

In order to ensure proper function over the lifetime of the tap, smoothly operate the handle and pull-out spout during use. When installing do not over tighten the locking nut. Regularly clean the tap with a soft, damp cloth and avoid abrasive cleaners, steel wool, and strong chemicals.

Working Specifications

Working pressure: 20-100 psi

Working temperature: 1-60°C

This tap must be installed in accordance with the AS/NZS 3500 series standard. All ZOMODO taps are strongly recommended to be installed by a licensed plumber. Improper installation may void the warranty.

Notes

1. All pipework must be thoroughly flushed prior to installation as foreign materials may block the flow.
2. Aerator and the flow control can be removed with standard tool and cleaned.
3. If a screen-filter is fitted into the tap, remove it and flush the pipes and tap to remove grit. Then re-insert the screen.

KTC045-BR

Parts List

- 1 Tap body
- 2 Spigot brush
- 3 Spout o-ring
- 4 Spout wearing ring
- 5 Spout o-ring
- 6 Spout
- 7 Tap spout snap buckle
- 8 Check valve
- 9 Pull-out head
- 10 Aerator
- 11 Aerator key
- 12 Weight ball
- 13 Cartridge
- 14 Cartridge nut
- 15 Handle cover ring
- 16 Tap handle
- 17 Grub screw
- 18 Silicon plug
- 19 Allen key
- 20 Tap base plate
- 21 Tap base o-ring
- 22 Pull-out hose plastic guide
- 23 Widget for tap support, plastic
- 24 Steel washer
- 25 Rubber gasket
- 26 Steel locking nut
- 27 Screws
- 28 Thread tail
- 29 Quick-connect hose
- 30 Check-valve
- 31 Tap braided hose blue
- 32 Tap braided hose red
- 33 Pull-out hose

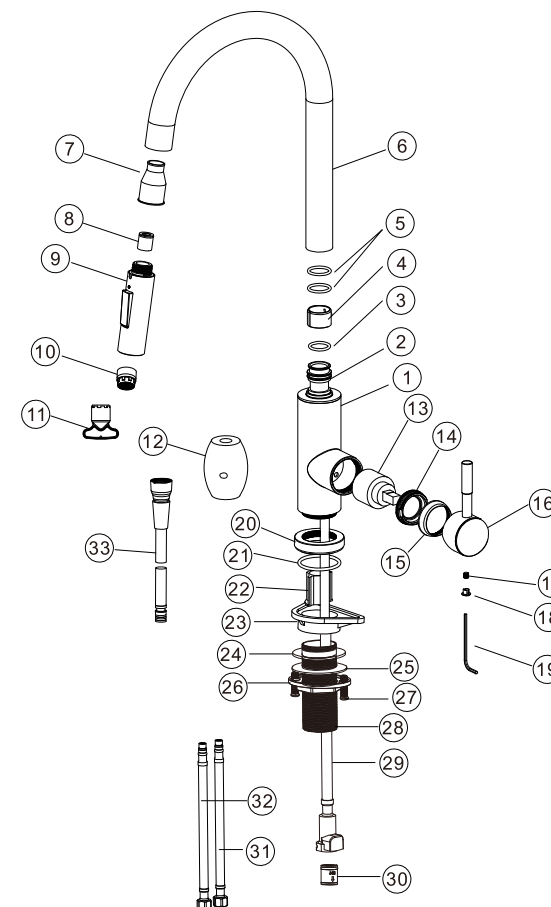

KTC045-BR

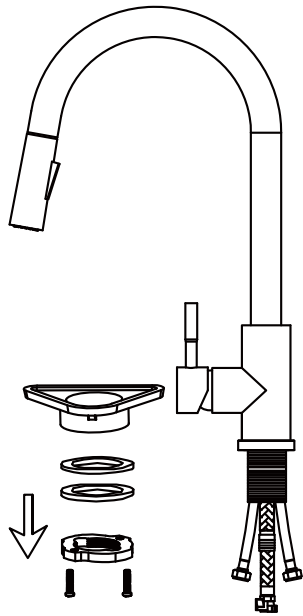

Step 1

Remove steel locking nut (26), washers (24, 25) and widget for tap support (23) prior to installation.

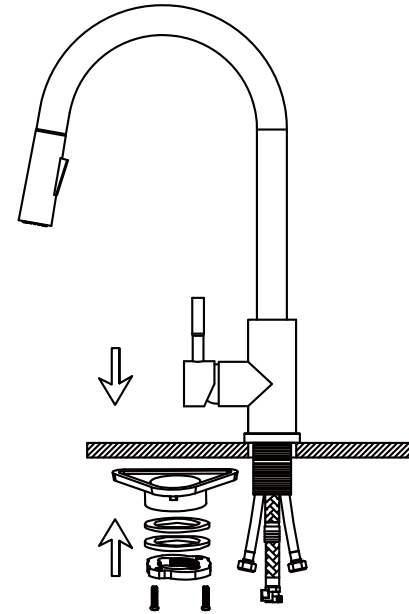

Step 3

Install tap through center hole and re-install widget for tap support (23), washers (24, 25) followed by the steel locking nut (26). Re-install hose connector if removed insuring small rubber washer is also installed. Using a screwdriver tighten the screws (27) so that the tap is secure and will not twist.

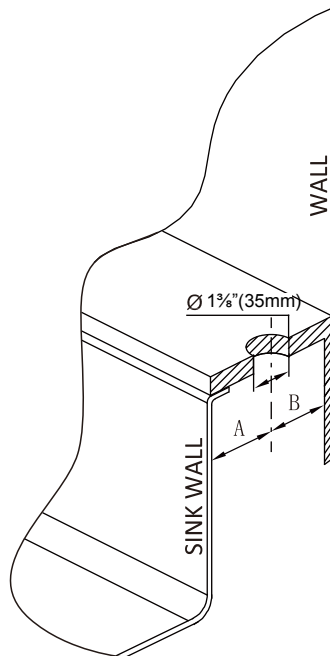

Step 2

Locate a position in the countertop at least 50mm from the wall and with enough clearance to the rim/flange of the sink. Dim. A > 50mm (2") and Dim. B > 50mm (2"). If you need to locate the tap within these dimensions, you should ensure enough clearance for the mounting washers and nut (23, 24, 25, 26). Cut a hole 1 3/8 (35mm) diameter into the countertop.

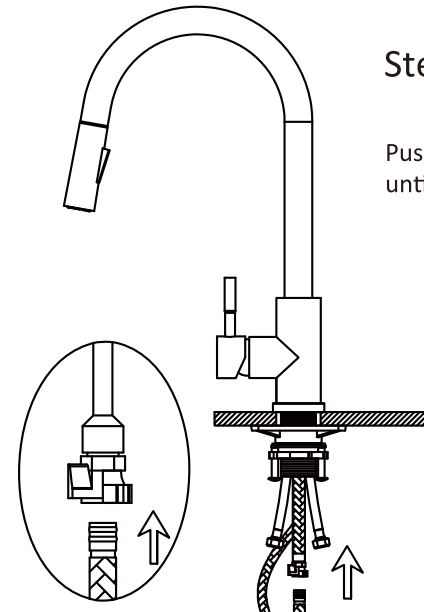

Step 4

Push pull-out hose (33) in to the hose connector until you hear a click sound.

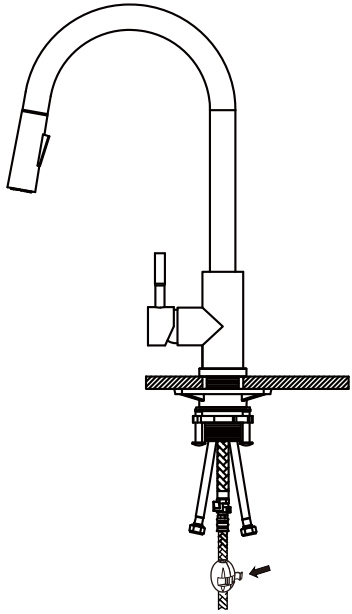

Step 5

Proper installation of the hose weight kit (12) will ensure that the spray head retracts smoothly. On the spray side of the hose, measure 15" down from the body of the tap. Install the hose weight kit at this point. Pull out on the spray head. It should move easily and retract smoothly. Reposition the hose weight kit as necessary.

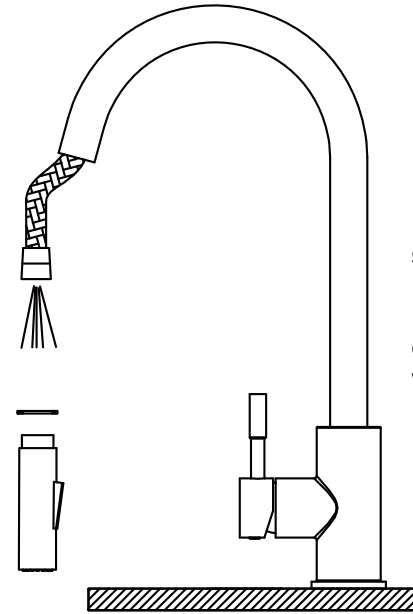

Step 7

Hold on to the spray-head (9) hose and unscrew spray head and remove it along with the rubber washer. Turn on the tap to flush the hose and feed line for 1-minute to flush debris. Turn off tap and re-install the rubber washer and spray head.

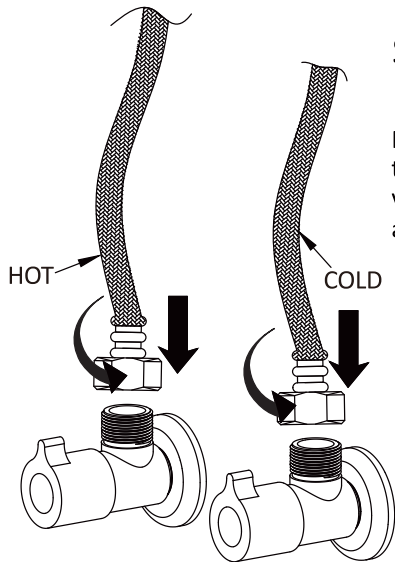

Step 6

Flush the wall valves to ensure no grit enters the tap. Now attach the hoses to the wall valves ensuring the hose with RED braid attaches to the hot water outlet.

Step 8

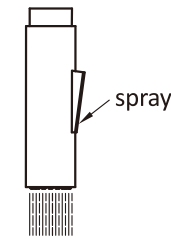

Figure 1

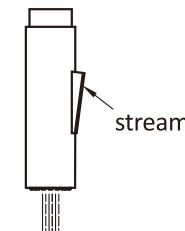

Figure 2

Turn the tap on and press the top of the spray (9) head button to change to spray. (As figure 1)
Turn the tap on and press the bottom of the spray (2) head button to change to stream. (As figure 2)

Troubleshooting

1. If water is leaking you should retighten the water inlet hoses (H/C) (31,32).
It is possible that these connections have loosened when the water inlet hoses (H/C) are tightened to the wall valves.
2. If the water stream is uneven it is possible that debris or grit has blocked the aerator. You can remove the tip of the spout and backflush the aerator. Firmly retighten the retaining nut.
3. If the tap is lose or rotating at the base as it enters the countertop you should retighten the steel locking nut (26) ensuring the handle lever assembly is correctly positioned.
4. If the spout (6) is loose at the connection to the body (1) you may need to gently tighten the small grub screw, do not over tighten the grub screw or the spout will not rotate.