

# RHS06-316C Installation Guide

1. The hand-shower holder can be located either above or below the top wall connector (A). It is supplied fitted above. To reposition the holder, you need to loosen the grub screw (B) and remove the top arm from the wall connector. Remove the holder (C) and reconnect the arm to the wall connector.
2. Loosen grub screws (D) and remove the threaded insert (E) by temporarily attaching the male thread of the bottom rail (J). Apply thread tape to male thread of lugged elbow (F) (protruding from the wall). Screw bayonet fitting onto lugged elbow.
3. Remove brass insert (G) from bottom wall connector assembly by loosening grub screw (H). Position the brass insert on the wall. The centre should be 540mm below the centre of the top wall connector. Mark screw positions on the wall. Drill 2 x  $\phi 6$ mm holes and attach brass insert with raw-plugs (I) and screws provided.
4. Attach bottom rail (J) to top wall connector. No thread tape required. Slide the cover plates (K) onto the top and bottom wall connector assemblies.
5. Insert the rail onto the top bayonet fitting and bottom brass insert simultaneously. Tighten grub screws (L).
6. Fit top showerhead (M) ensuring that the seal and flow control are in the correct position. And attach hose to bottom threaded outlet (N) and hand-shower to the hose ensuring flow control is fitted correctly.

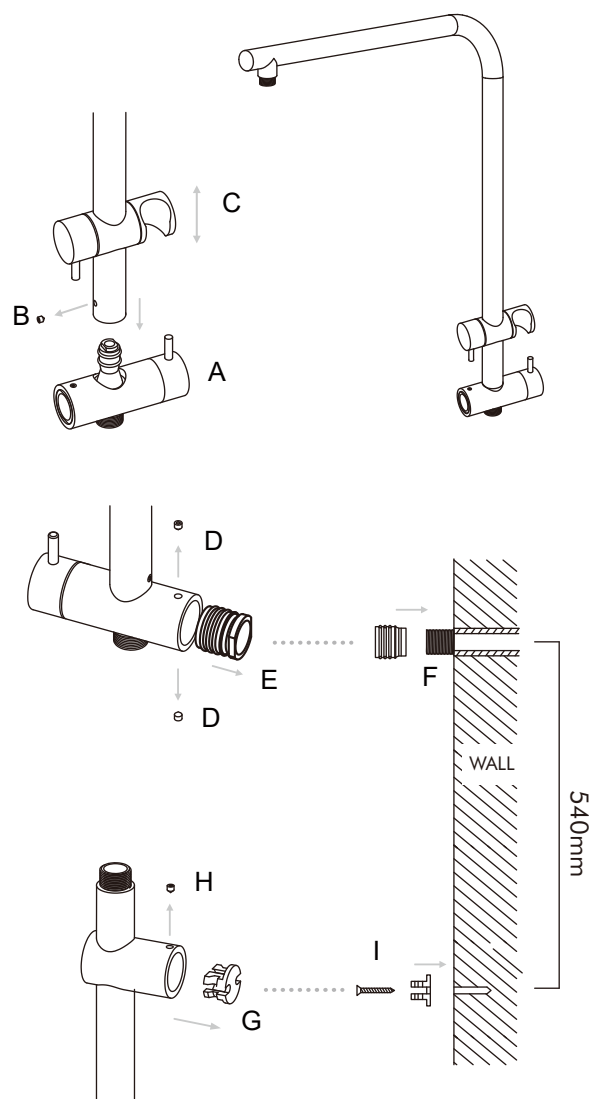

**Note:** The flow control should be inserted with the protruding side into the showerhead, taking care not to cause and damage to the flow controller. These showers may not be suitable for use with gravity fed waterheaters, low and unequal pressure supply networks, instantaneous water heaters, tempering valves and/or thermostatic mixing valves. The removal of the overflow controller will void the warranty.

The following pressure range should be complied with:

- Minimum working pressure 150 kPa / 22psi
- Maximum working pressure 750 kPa / 109psi

All showers must be installed in accordance with applicable plumbing codes (UPC, IPC, or NPC).

All showers are manufactured to meet ASME A112.18.1 / CSA B125.1 standards and carry WaterMark certification (WM-032384) certification which is equivalent to cUPC certification.

